

HOGTUNES

Audio Solutions For The Great American Cruiser



REV 200SG KIT-AA

High Performance Front Speaker and Amplifier Kit

FOR USE ON 1998-2013 "BATWING" MODEL BIKES WITH FACTORY RADIOS

INSTALLATION MANUAL (V1.1)

Thank you for choosing the Hogtunes REV 200SG Kit-AA for 1998-2013 “Batwing” Model Bikes. Since positive word of mouth is the best way to grow our business, we want your new system to work as well as it was designed to. If you have any questions or concerns, we are here to help.

The REV 200-AA Amplifier is a Class D design. We chose this design because it yields plenty of power, is easy on the bikes charging system and produces little heat. It should be understood that ALL Class D amplifiers may cause a reduction in FM reception. Nothing is affected when playing CD, MP3, Satellite radio or any other music device. FM reception will differ and depend on the condition and type of antenna that you are using and, although every effort has been made to minimize any loss, we strongly advise against the use of in-fairing or hidden antennas with Class D amplifiers for best FM reception.

To help protect your bike’s electrical system and battery, the amp has a built in feature where it will turn itself off if it sees less than 10.5 volts whether the bike is running or not. If you’re listening to your stereo while not riding, this feature can help protect your battery so the bike can still start. If you’re riding and the amp shuts off, this could be showing a potential issue with your charging system. If this feature is activated and the amp shuts off, it will turn the amp back on again if the voltage exceeds the 10.5 volt threshold.



*A video version of this manual is available at **www.hogtunes.com** If you still need assistance, please consider a professional installation by your motorcycle dealer.*

Hogtunes Contact Information

Email: tech@hogtunes.com

Tel: 705-719-6361

GETTING STARTED

- Step #1: Remove the seat and both wires (+ and -) from the battery.
- Step #2: Remove the outer fairing/headlamp assembly and set it aside. Refer to a service manual if you need help with this. NOTE: A towel on the front fender can help prevent scratches or "dings" from dropped tools or fasteners etc. *Expletives will also be kept to a minimum!*
- Step #3: Take the 2 wires off each front speaker by gently pulling one at a time. Undo the screws that attach each speaker/grill assembly to the inner fairing and remove. Pull the stock speaker out of each grill assembly.
- Step #4: "Clip" the Hogtunes speaker into each grill assembly. Position your new speaker/grill assembly onto the inner fairing and re-attach each one using the OE screws. Although a hand driven tool is suggested for this, the screws need to be tight enough so the speaker/grill assembly will not rattle during riding and potentially cause a false warranty claim.



Diagram 1.1

Standard, Street Glide, EG Classic.
No CB/XM Module Present



Diagram 1.2

Ultra Classic. Shown mounted
on top of CB Module

The amplifier gets mounted to the top of the factory radio using the supplied "hook and loop" adhesive and must sit so you can read the badge on top of the amplifier as in diagram 1.1. The amplifier needs to mount as far back on the radio as possible so the fairing can go back on. The minimum distance from the back of the radio to the most forward edge of the amplifier is 5/8" (15mm). On pre-2006 model bikes, it is a tight fit-but will go. 2006-2013 (Advanced Audio) radios have a "bump" on top of the radio that runs from front to back down the center of the radio. Cut the adhesive in half and apply each piece on either side of this bump. The amp will then mount flush. Most adhesives work best at room temperature or higher. NOTE: 2006-2013 Ultras have the CB module on top of the radio. The amp will adhere on top of the CB module so it is "half on/half off" this module as shown in Diagram 1.2. The supplied adhesive is plenty strong for this! The amp can adhere on top of the CB and one other module without issue.

AMPLIFIER WIRING DIAGRAM



Clutch-side factory speaker wire plugs into yellow/black on amp

Brake-side factory speaker wire plugs into green/black on amp



Orange wire goes to center pin on cigarette lighter

Power and ground DIRECT to battery

Brown/Black wire plugs into clutch-side speaker

Blue/Black wire plugs into Brake side speaker

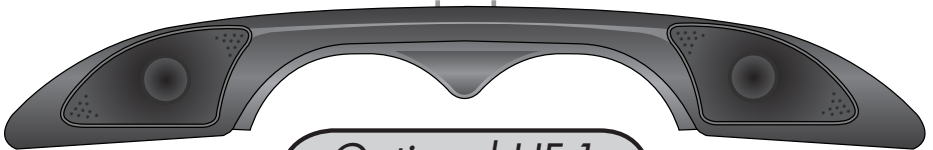
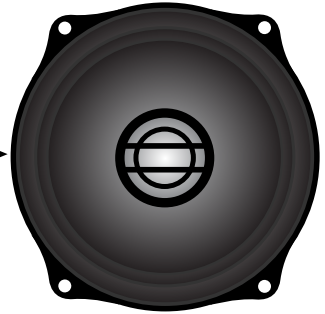
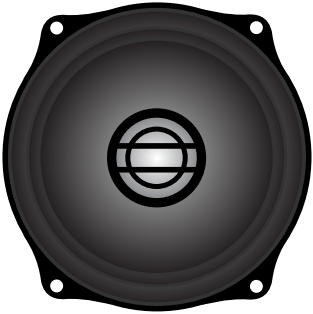

Optional HF-1 Tweeter Pod

WIRING THE AMPLIFIER

Step #1: Locate the main power harness and plug it into the matching connector on the amplifier. Locate the 8 pin harness and plug it into "Audio Input" on the side of the amp.

Step #2: On the audio input harness, locate the wire with the yellow heat shrink on one end. Unplug the factory speaker wires on the clutch side of the bike and plug the male connectors near the yellow heat shrink in to those. They will only go in one way. Also on the audio input harness, locate the wire with the green heat shrink on one end. Unplug the factory speaker wires on the brake side of the bike and plug the male connectors near the green heat shrink in to those. There is a black wire on the input harness with a "ring terminal" on one end which must attach to the radio using one of the screws as shown in Diagram 1.3

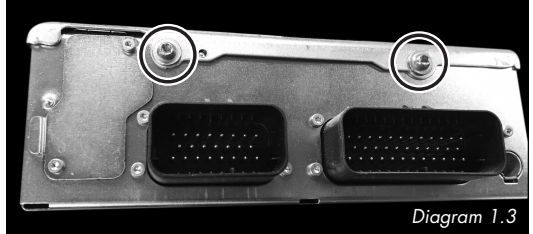

NOTE: The blue 4 pin plug with black wires on the input harness is an "expansion port" which is used to send music to a second amp or is used to send radio power to run other speakers on the bike. You can see how the expansion port can be used in the system upgrade section of this manual.

Step #3:

- On the opposite side of the amp are 3" (75mm) wires ending with a 4 pin black connector. This plug sends amplified power to your speakers. Locate 4 pin black plug wire harness with brown/black and blue/black wires and plug it into the amplified output plug.
- The blue/black wires will plug directly to the speaker on the brake side of the bike. The brown/black wires will plug directly to the speaker on the clutch side of the bike.

Step #4:

- The orange wire is the "remote turn on lead" and tells the amp to turn on whenever it sees +12v (.5 amp min.). Unplug the factory center wire (+) on the cigarette lighter.
- Plug the orange lead from the amplifier directly onto the lighter using the female connector.
- Plug the factory lighter wire to the male "take off" connector which is part of the amps orange turn on lead.

ROUTING THE POWER HARNESS

For '98-'06 bikes, the power harness will pass under the inner fairing where the throttle and idle cables pass through on the brake side of the bike. The harness is designed to be routed between the frame backbone and gas tank on the brake side of the bike and come out just behind the gas tank. You MAY need to undo the back bolt of the gas tank and pivot the tank up to allow the harness to pass through at the back of the gas tank. Be sure to re-install this bolt and torque to factory specs!

For 2007-2013 bikes, the balance of the main wire harness will pass under the inner fairing where the main wire harness passes through on the brake side of the bike. Loosen the tank console and run wires up and over the gas tank, but under the tank console. There is a provision on the front of the tank console for wires to pass. Secure the amplifiers harness to the bikes factory harness using zip ties. When correctly installed, the power and ground wires are the right length to connect onto the battery.

- Attach the red wire to the positive (+) battery terminal and the black wire to the negative (-) battery terminal. The factory battery wires are also re-installed at this point. Turn the ignition of the bike to the "on" position and play the stereo at low volume to verify the amplifier is working fine.

IMPORTANT: With all wires secured, turn the front wheel to each extreme side making sure that any wires cannot bind or impede the steering of the motorcycle. Failure to do so can cause an accident resulting in serious injury or death!

On the brake side of the amplifier is the amp level switch. The switch has 3 positions labeled -3, 0 and +3.

- If the expansion port has been used to power additional speakers, use the switch to set the "balance" between the amplified fairing speakers and additional speaker powered by the radios built in power.
- If you have a dual amp system, you can use the switches on each amp to balance the level of sound to each set of speakers as a means to tailor the sound to your liking. In a multi amplifier system, this gives you AWESOME flexibility! Diagrams of bigger systems are shown on pages 7, 8 and 9 of this manual.

SYSTEM UPGRADE #1

This system is an easy way to add rear speakers to your bike if you've added a King Tour-Pak®. Houghtunes rear speaker pods come with a wire harness set up for quick detach tour paks that will plug right into the expansion port on the amp. **IMPORTANT:** Since the RADIO power will be used to power the rear speakers, you must use rear speakers specific to your year of bike!

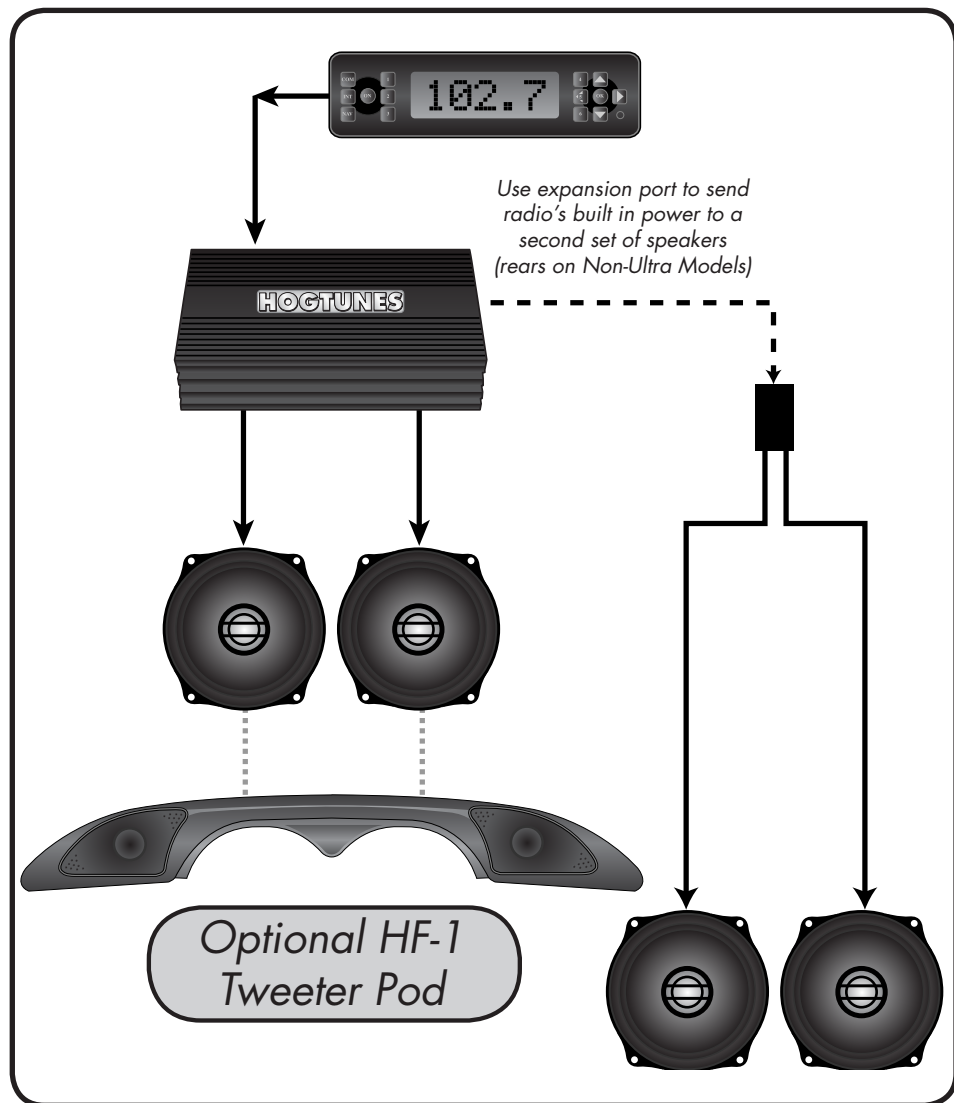

SYSTEM UPGRADE #2

This system has the incredible power of 2 REV 200-AA Amplifiers to your bike! The first amp will run the 5.25" fairing speakers and HF-1 Tweeter Pod (if present). The second amplifier is used to power a set of 692.2/Lids, FL-7W fairing lower woofers or rear tour pak speakers.

For all Standard/Classic/Ultra/Street Glide models, the purchase of Hogtunes 2CHSP adaptor kit is required! The metal plate in that kit is used to bolt the second amplifier into your fairing between the brake side speaker and radio.

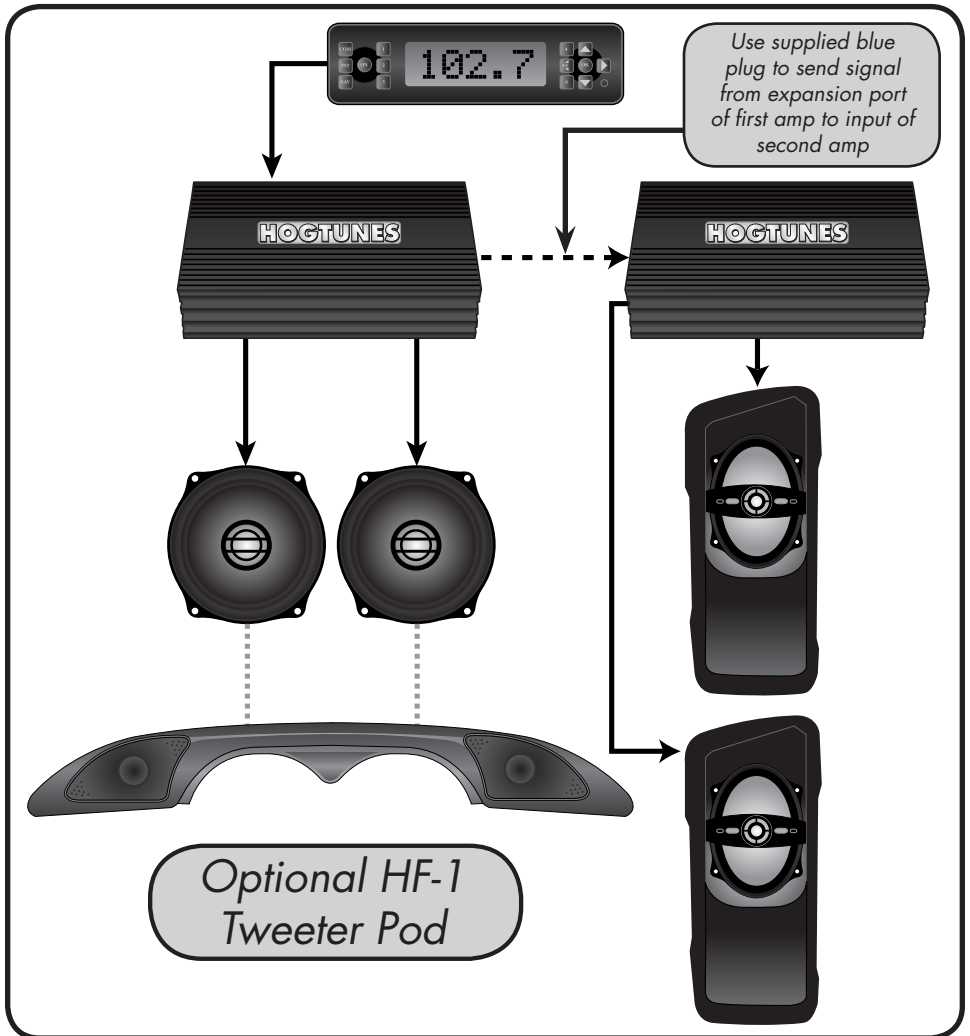

SYSTEM UPGRADE #3

This system adds a Hogtunes 4 channel amp; where 2 of its channels would power the front speakers (and tweeter pod if present) and the other 2 channels would power rear speakers or fairing lower woofers. The original 2 channel amp would power 692.2/lids or lower speakers. You can literally build the system the way you want based on the body work you have on your bike. This can be done at any time, all bolt in, all plug and play! Hogtunes 2CHSP mounting plate is required to bolt the REV 200-AA into your fairing.

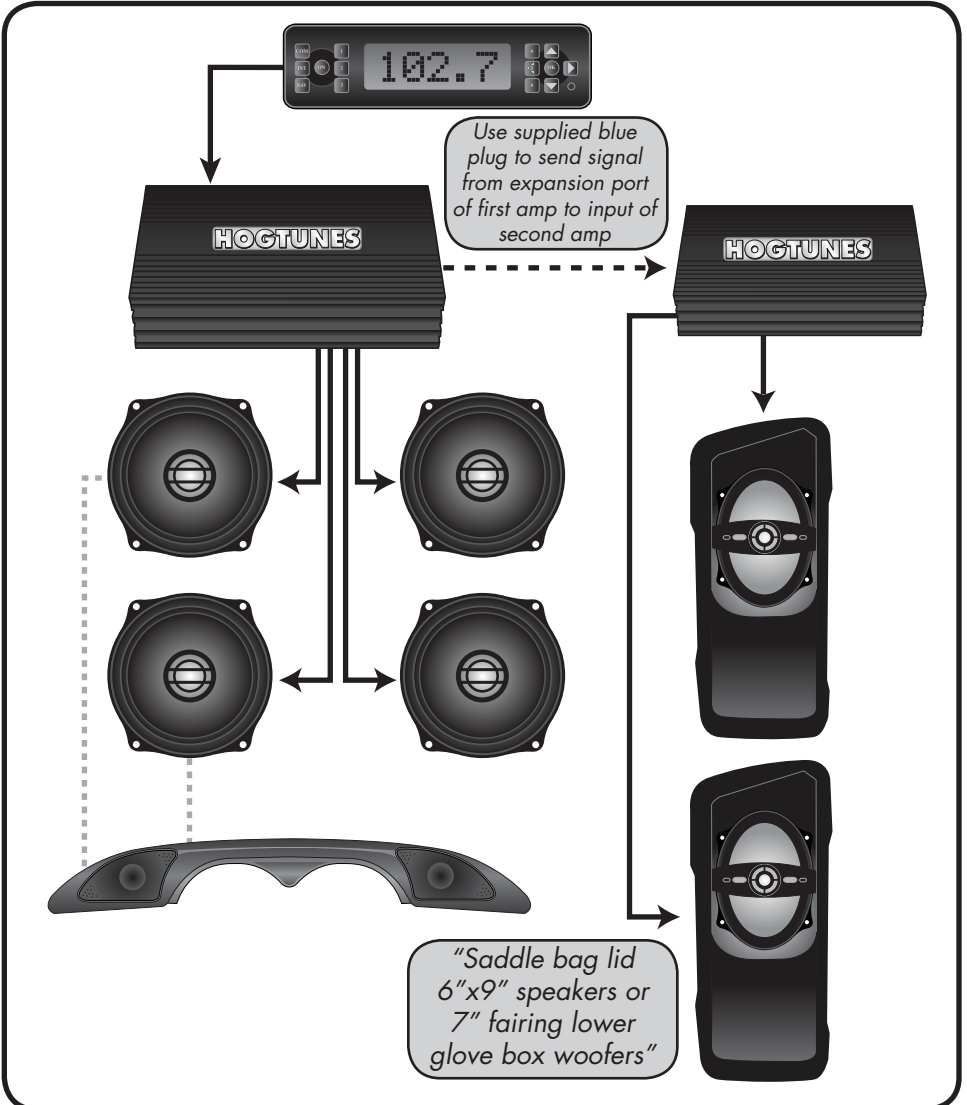

ADJUSTING YOUR SYSTEM-PLEASE READ!

In order to make your new system perform as good as it was designed, please take a minute to understand and follow these tips:

- 1) Set your "Automatic Volume Control" (AVC) to 3 bars. After extensive on-road testing, we found that this AVC position works and sounds best. Your new amplifier has been specifically set-up for this radio setting.
- 2) Your Hogtunes system is designed specifically for a motorcycle at speed. Exhaust noise and wind noise have been taken into careful consideration in how your system performs. How your new system sounds in a driveway or garage is radically different from how it will sound at highway speeds. Although your system was set-up with a factory radio, with its bass and treble controls in the middle position, if you feel the need to make adjustments please do so (carefully) at your normal cruising speed.
- 3) If you have an aftermarket car radio on your bike, everything will work fine. Please remember that car radios are designed to work in an environment with little or no exhaust or wind noise. Many car radios have features such as equalizers, loudness contours, surround effects, etc., all designed for a quiet environment and all of which will hurt your ability to hear your motorcycle system at speed if left on. Please take a minute and turn as much of these "features" off. With a car radio in your bike, the only adjustments you should be able to access for best performance are volume, bass, treble, balance and fader.
- 4) If you're using an external device to supply music through the radios AUX port, we have an article on our website that can help make your peripheral audio device sound as good as it can. The article is at: http://www.hogtunes.com/techzone_files/Level_matching.pdf

TECHNICAL SPECIFICATIONS

Hogtunes REV 200-AA Amplifier

RMS Power at 2 Ohms:..... 100 watts x 2
Freq. Response:30hz-25khz
Fuse at Amp: 15 amp

Hogtunes 352F-AA Front Speakers

Power Handling: 100 RMS-150 Peak
Frequency Response:55hz-25Khz
Sensitivity:92 db 1watt/1meter
Nominal Impedance:2.0 Ohms
Cool Factor:EXTREME

WARRANTY INFORMATION

Please Record Your Amplifier's Serial # Here _____

Hogtunes speakers are warranted for a period of 20 years. The REV 200-AA Amplifier is warranted for 3 years from original purchase date. Proof of purchase is required for all warranty claims. The warranty applies to the original retail customer and is not transferable. Please contact Hogtunes for all warranty claims. Products found to be defective during the warranty period will be repaired or replaced (with a product deemed to be equivalent) at Hogtunes sole discretion. Hogtunes complete warranty policy is available on our website at www.hogtunes.com/warranty.html

What Is Not Covered:

- 1) Any expense related to the removal or re-installation of Hogtunes products.
- 2) Repairs to these products performed by anyone other than Hogtunes.
- 3) Subsequent damage to any other components.
- 4) Any product purchased from a non-authorized Hogtunes dealer.
- 5) Damage to Hogtunes products due to an accident or collision.
- 6) Hogtunes Amplifiers with broken or removed "warranty void" stickers.
- 7) Damage due to water from custom installations.
- 8) Damage from incorrect installation, improper use, abuse or modifications.
- 9) Damage to inbound product due to improper packing.

Harley-Davidson, Electra Glide, Road Glide, Street Glide, Ultra Classic, Tri Glide, CVO, Screamin Eagle and Tour-Pak® are Trademarks, and/or Registered Trademarks of Harley-Davidson, Inc., Milwaukee, Wisconsin, USA, and if Used or Implied are for Reference Only. There is No Affiliation Between Harley-Davidson, Inc., and Hogtunes Inc.



Hogtunes products will play much louder than the Original Equipment, which can be a distraction to the rider and/or passenger. Please use caution when adjusting, or playing your stereo at high volume, especially in traffic.

You are a valued customer so please:

**Ride Alert
Arrive Alive!**

www.hogtunes.com